

BODY ASSEMBLY

20 SUB-ASSEMBLY A: FIREWALL/HOOD

NOTE: The HOOD, BODY and all other non-plated exterior body parts should be painted together.

(Paint all trim, door handles, window molding, emblems and wipers: **[G]**)

22 CUSTOM HEADREST

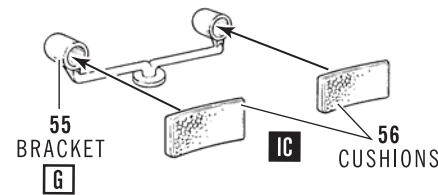

23 SUB-ASSEMBLY B: BODY/INTERIOR

NOTE: If you are planning to build one of the advanced custom versions shown on the other side, many of the parts shown on this side will not apply. However, there are certain items like the FIREWALL, WINDOW UNIT, RADIATOR and ASSEMBLED INTERIOR that you will need to include during assembly. Other items you may wish to include on an advanced custom version might be the HEADREST, SIDE MIRRORS, SPOT LIGHTS, FENDER SKIRTS, AIR HORNS OR CUSTOM EXHAUST. Using any or all of these parts you can create a truly unique custom model.

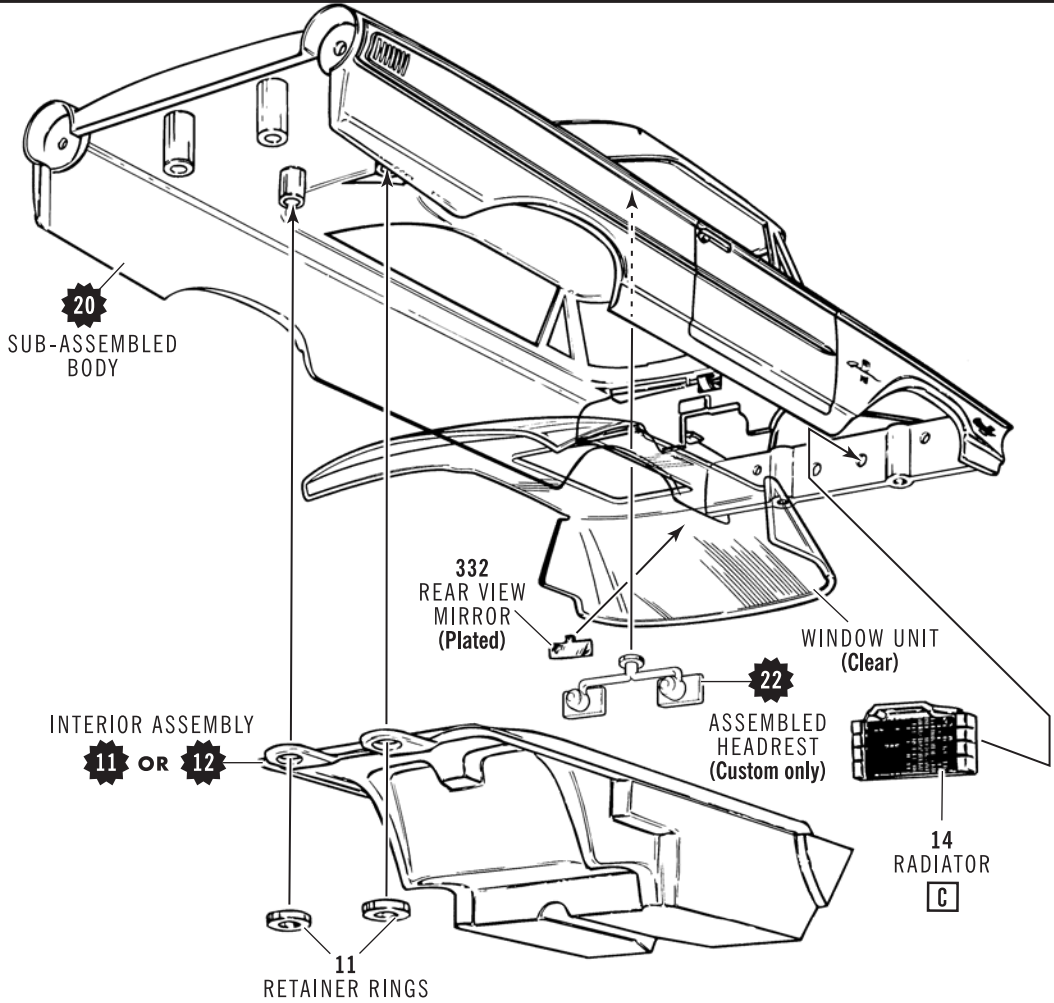

24 REAR BUMPER ASSEMBLY (STOCK)

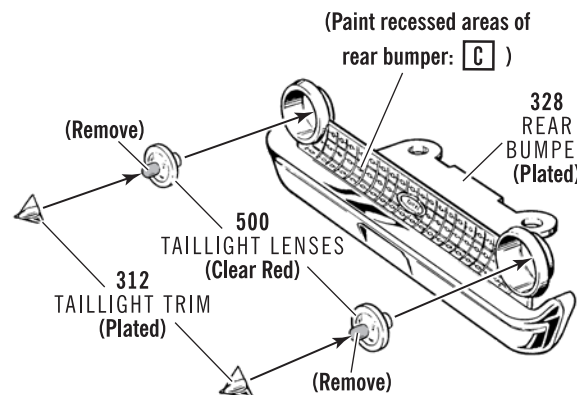

NOTE: Before removing taillight lenses (500) from sprue, carefully cut off taillight trim mounting posts, then add trim parts (312) to clear red lenses.

25 FRONT GRILLE ASSEMBLY (CUSTOM)

(Paint recessed areas of grille: **[C]**)

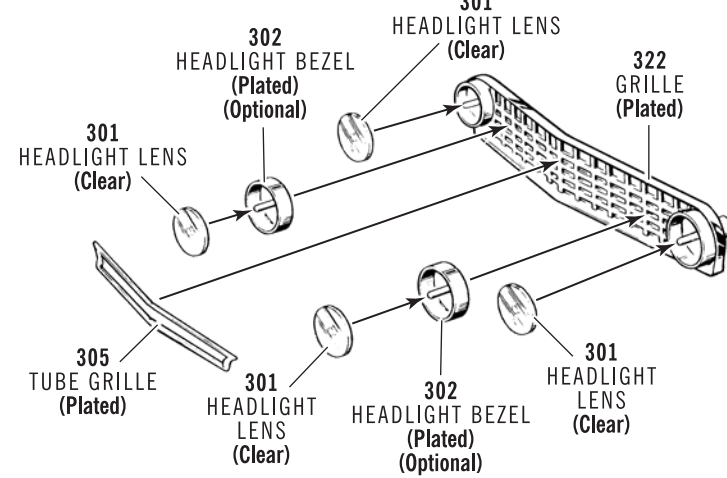

26 FINAL ASSEMBLY (STOCK)

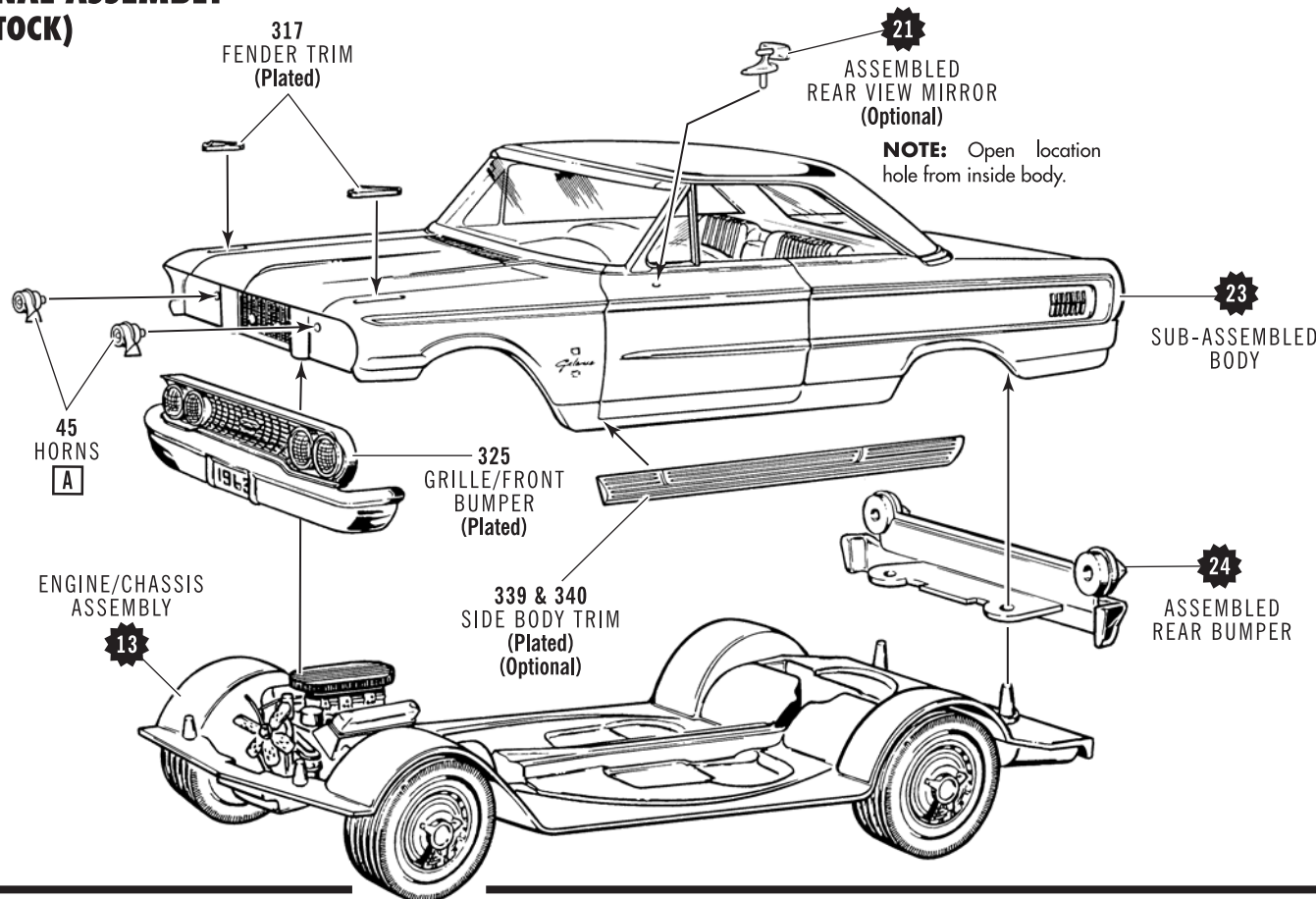

21 SIDE MIRRORS (Optional)

**STOCK (ASSEMBLE 1)
CUSTOM (ASSEMBLE 2)**

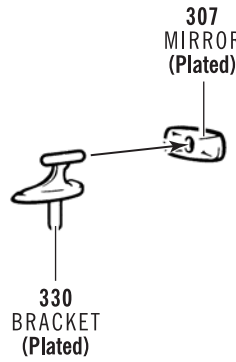

27 CUSTOM REAR END

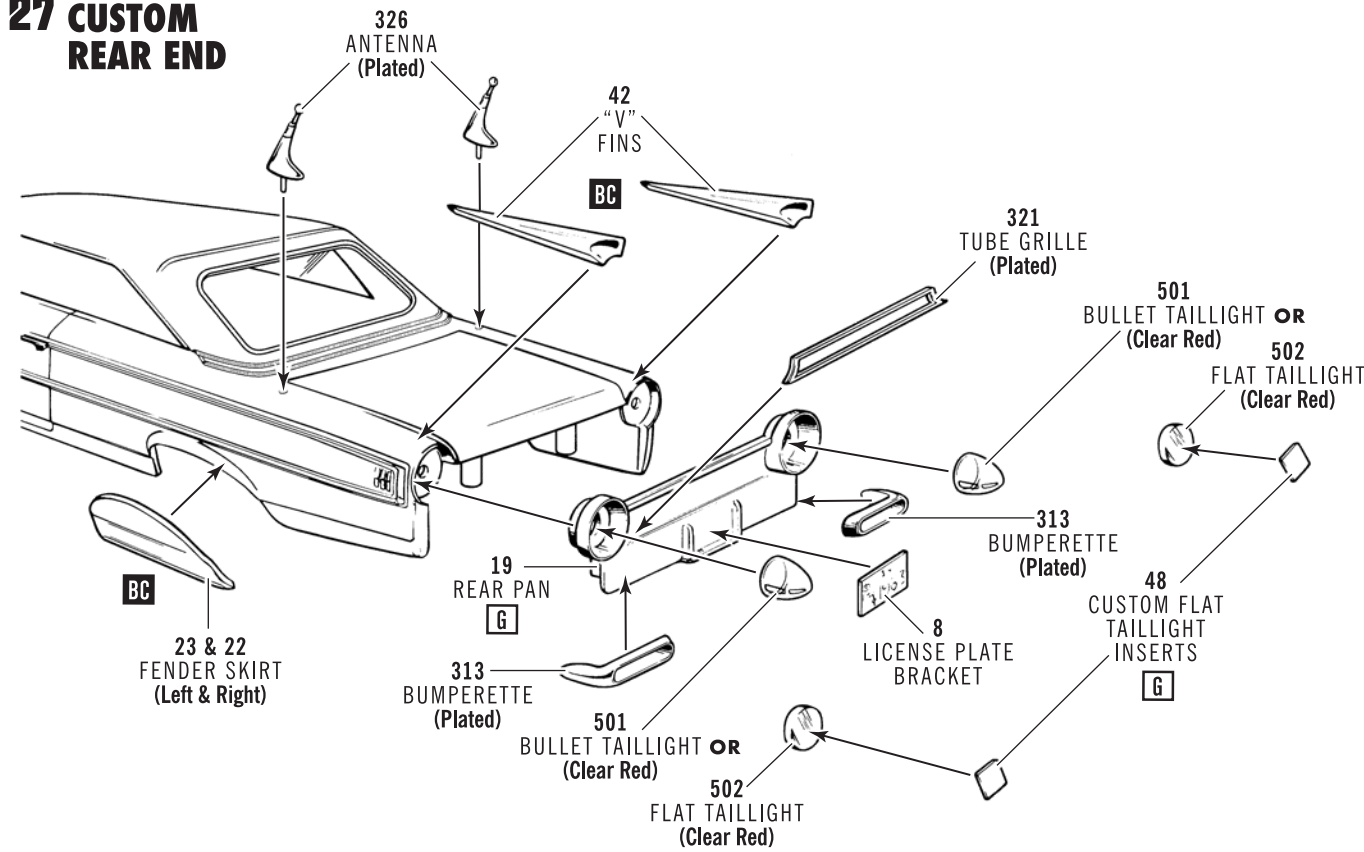

28 CUSTOM SPOT LIGHT (ASSEMBLE 2)

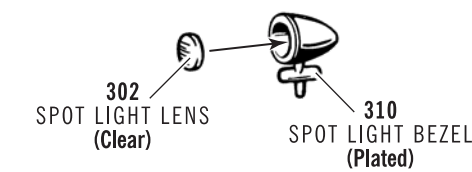

29 CUSTOM EXHAUST OPTION A (ASSEMBLE 2)

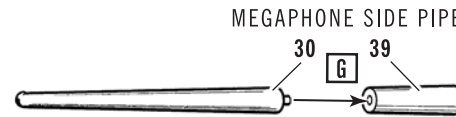

30 CUSTOM EXHAUST OPTION B (ASSEMBLE 2)

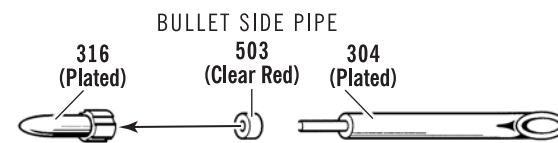

31 FINAL ASSEMBLY (CUSTOM)

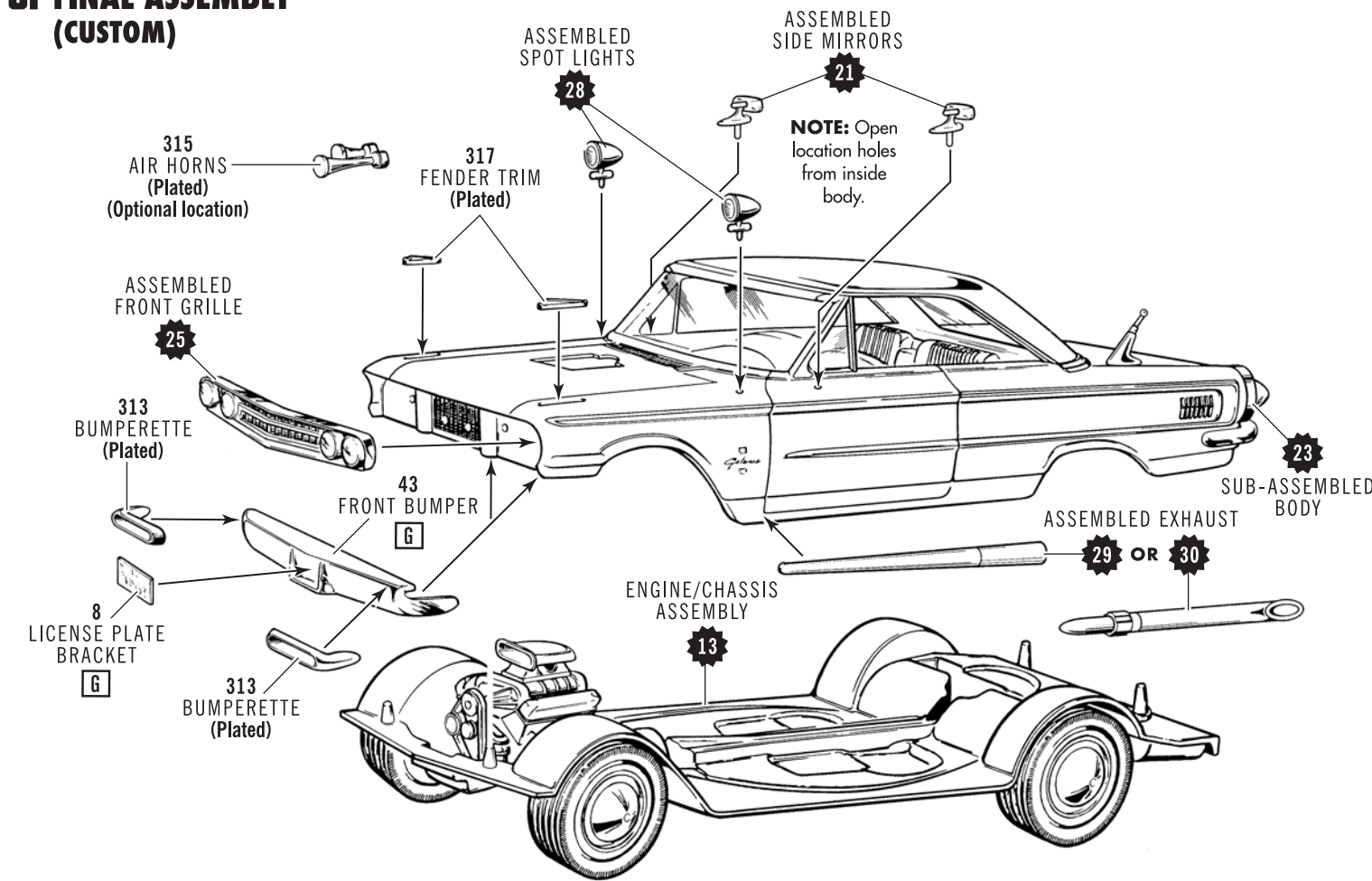

32 ACCESSORY ITEMS

NOTE: JACK STAND and ROTOR can be used to replace one of the wheels.

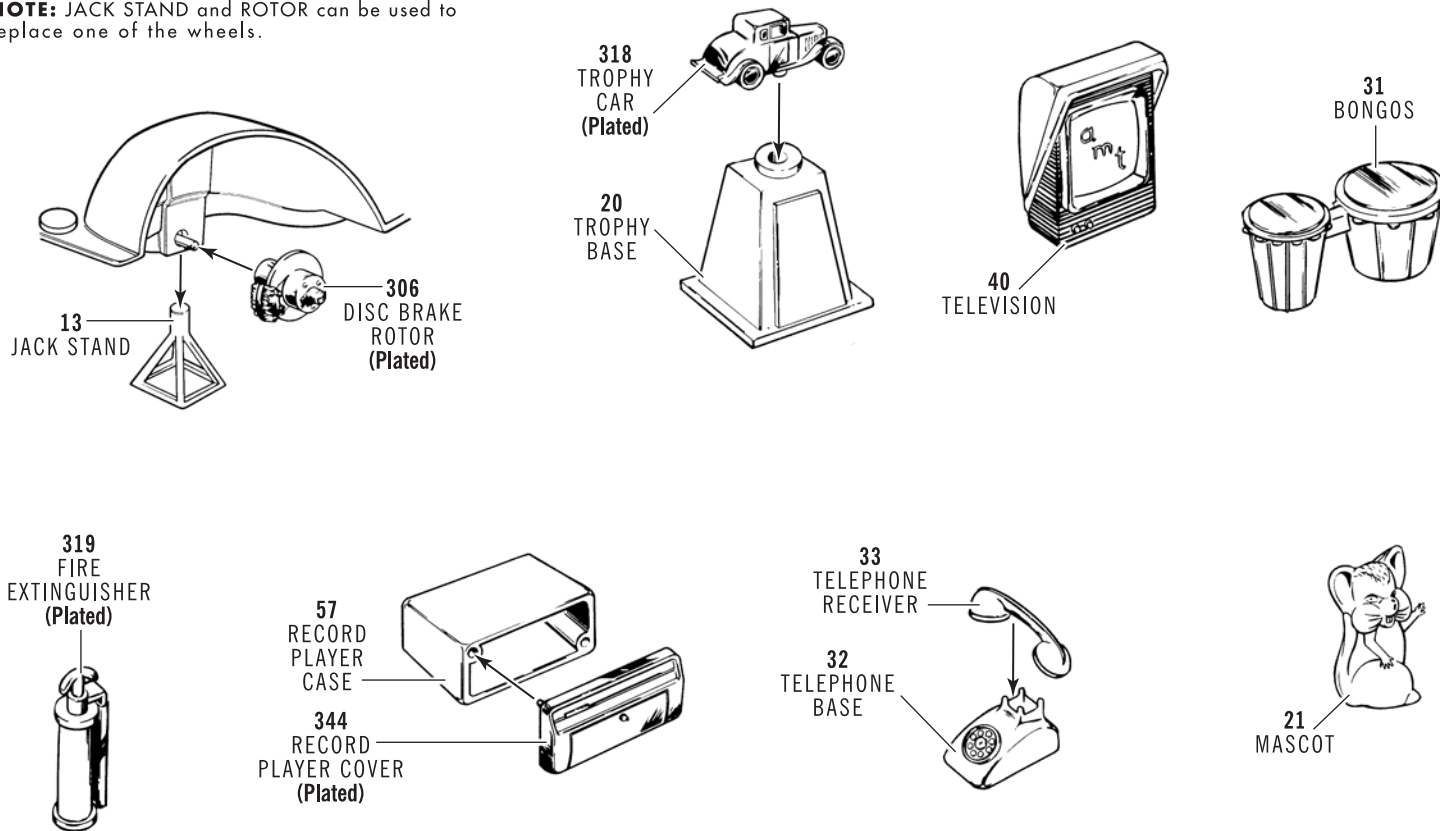

'63 Ford Galaxie 500 XL
ADVANCED CUSTOMIZING KIT



1/25 SCALE

IMPORTANT

NOTE: THIS KIT MAY BE BUILT 1 OF 3 WAYS. STOCK, CUSTOM OR ADVANCED CUSTOM. THE ADVANCED CUSTOM REQUIRES BODY PUTTY AND SANDING STICKS, WHICH ARE NOT INCLUDED. PLEASE READ THROUGH THE INSTRUCTIONS BEFORE STARTING.

Before you begin to assemble your model kit, study the instructions carefully. This will help you to familiarize yourself with the part locations as you proceed. Prior to cementing parts together, be sure to "TEST FIT" them in order to assure proper alignment and also to check for excess "FLASH" that may occur along parting lines. Use a sharp hobby knife or file to remove flash if necessary.

If you wish to paint your model, various sub-assemblies and components should be painted before any parts are attached. During assembly, you may note that the recommended color is stated after the part name.

This model kit is molded from the finest high-impact styrene plastic. Use only paints and cements which are specifically formulated for styrene. Read all labels and warnings carefully.

Because the cement will only adhere to bare plastic, it is necessary to remove any paint or "plating" from the area to which the cement is to be applied.

BUILDING TIPS FOR THE ADVANCED MODELER

For the best possible finish, your kit should be painted, even if molded in color. Paint should be applied evenly, in several thin coats rather than one heavy coat. The first coat should not completely cover the surface. Each layer should be allowed to thoroughly dry before the next is applied. Also, each coat should be "wet sanded", except for the final coat, using No. 1200 wet or dry sandpaper which is slightly damp. Be careful not to remove any detail while sanding.

It is important to keep your hands clean when working with your model. Wash parts thoroughly before painting to remove any mold release agent that may have been used during manufacture, body oil from your hands, sanding residue, and dust, which is naturally attracted to plastic by static electricity. Use a mild solution of dishwashing detergent and water. A tack rag should be used to dry the parts, DO NOT use paper towels or tissues, since they will leave lint on the part. Parting lines and glue joints should be sanded or filed prior to painting and cementing. Because paint has a tendency to draw away from sharp edges, they should be lightly filed. Use filler putty designed for plastic to fill small gaps that may occur between parts and to blend contours. This should be done only after the first, or "primer," coat of paint is applied.

When painting a two-tone body, the lightest color should be painted first. Use frosted, or "magic," tape to mask off the area you do not want painted. After the second color is dry to the touch, the tape can be removed. Use a very fine brush to touch up edges if necessary. If decals are to be added, do so before adding any gloss coat. A gloss coat will help even out the edges between the two colors as well as set the decals.

RECOMMENDED TOOLS

HOBBY KNIFE

Use a sharp hobby knife to remove parts from the trees. The knife may also be used to remove parting lines and flash.

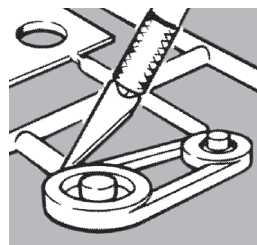

TWEEZERS

Use tweezers to hold small parts during assembly, painting and when applying cement.

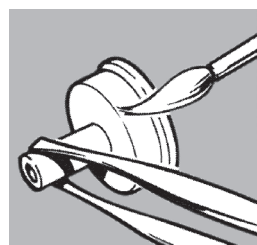

BRUSH

We recommend the use of liquid polystyrene cement. Apply with a fine brush. Use sparingly or a sloppy job will result.

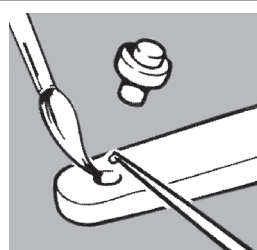

READ ALL LABELS AND WARNINGS CAREFULLY

SYMBOL INDEX

31	36	18
ASSEMBLY SEQUENCE	PART NUMBER	COMPLETED ASSEMBLY

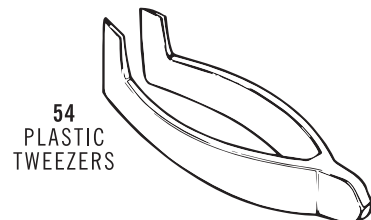

We have included tweezers to help hold the smaller parts.

PAINT COLORS

A Black	Q Yellow
B Flat Black	R Tan
C Semi-Gloss Black	S Brown
D White	T Lt. Blue
E Flat White	U Med. Blue
F Silver	V Dark Blue
G Chrome (Bright Silver)	W Ford Motor Blue
H Aluminum	X Lt. Green
I Steel	Y Dark Green
J Brass	Z Gray
K Gold	AA Purple
L Amber	IC Interior Color
M Transparent Amber	BC Body Color
N Red	▲ Semi-Gloss
O Transparent Red	▲ Gloss
P Orange	▲ Metallic

EXTERIOR COLORS

Standard Colors Include: Black, Peacock Blue, Ming Green, Viking Blue, Oxford Blue, Castilian Gold, Champagne, Rangoon Red, Corinthian White, Silver Moss, Sandshell Beige, Chestnut, Rose Beige, Heritage Burgundy and Glacier Blue.

INTERIOR COLORS

Black, White, Red, Chestnut, Light Blue Metallic, Dark Blue Metallic, Light Turquoise Metallic and Dark Turquoise Metallic.

It is recommended that you search the internet for additional color references and details.



Ford Motor Company Trademarks and Trade Dress used under license to Round 2, LLC. Firestone and F Shield Logo are registered trademarks of Bridgestone Brands, LLC and are used with permission. AMT and design is a registered trademark of Round 2, LLC. ©2020 Round 2, LLC, South Bend, IN 46628 USA. Product and packaging designed in the USA. Made in China. All rights reserved.



SEE MORE GREAT AMT KITS!
VISIT US ONLINE AT...
round2models.com

ENGINE ASSEMBLY

1 STOCK SUB-ASSEMBLY

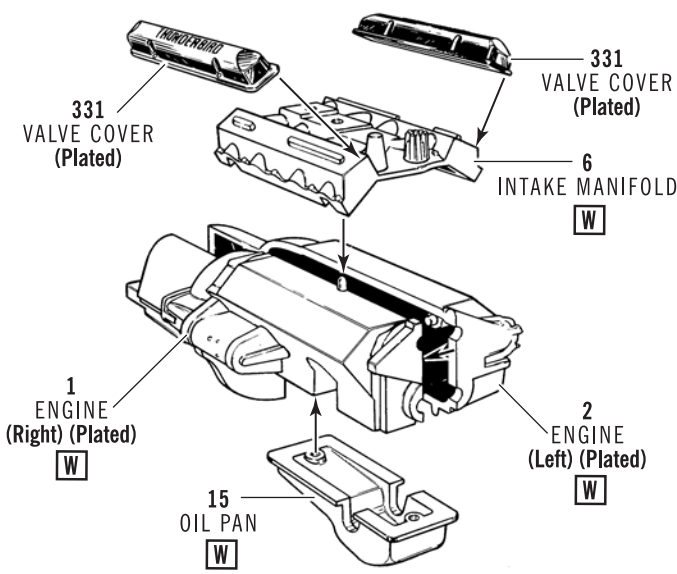

2 STOCK FINAL ASSEMBLY

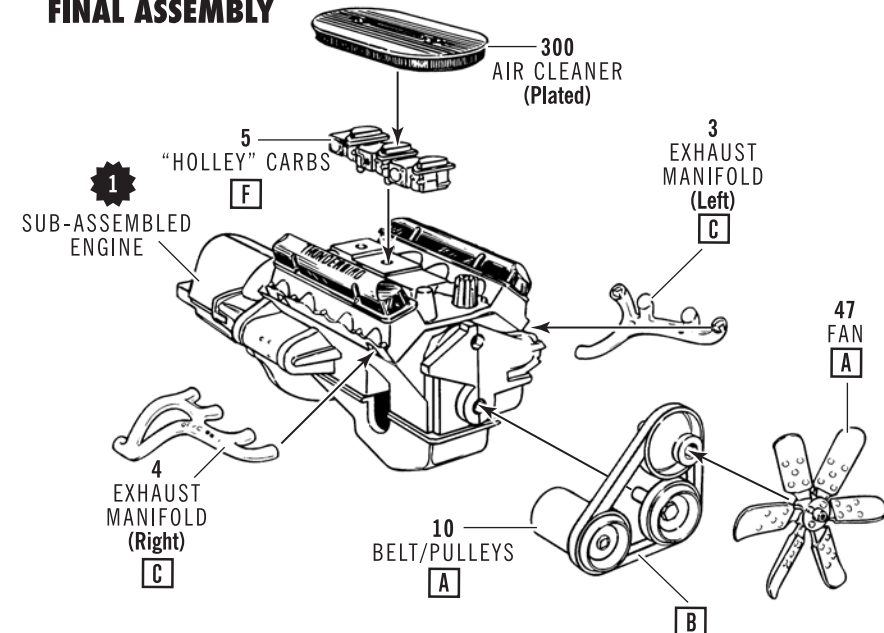

3 CUSTOM SUB-ASSEMBLY

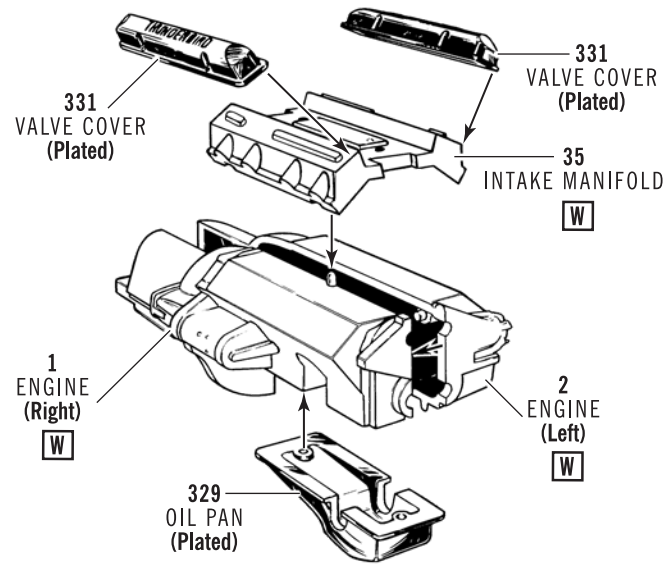

4 CUSTOM FINAL ASSEMBLY

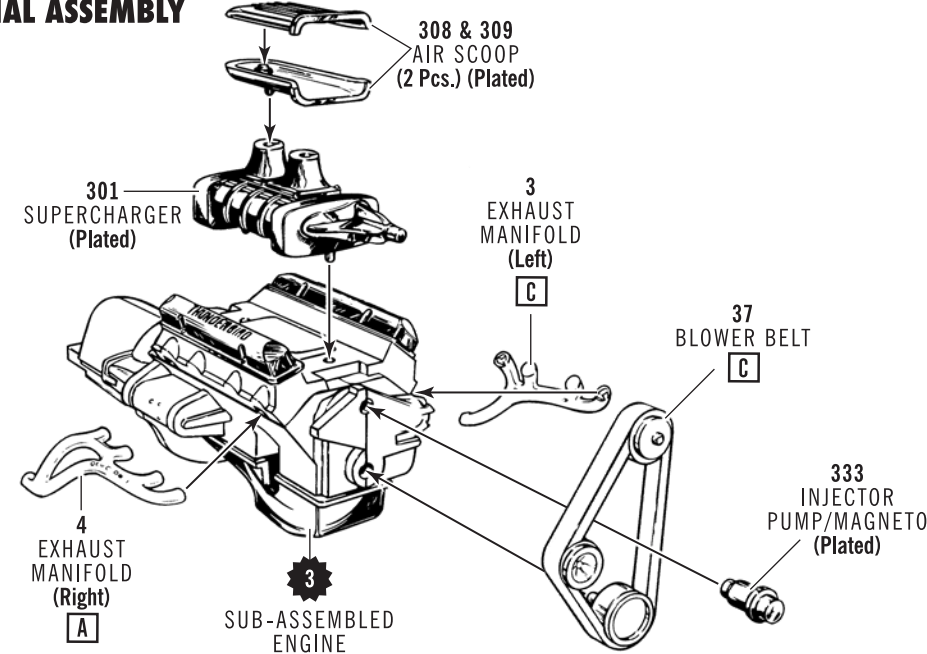

WHEEL ASSEMBLY

5 STOCK (ASSEMBLE 4)

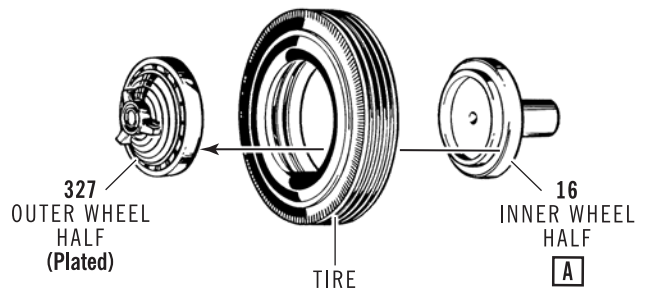

6 CUSTOM (ASSEMBLE 4)

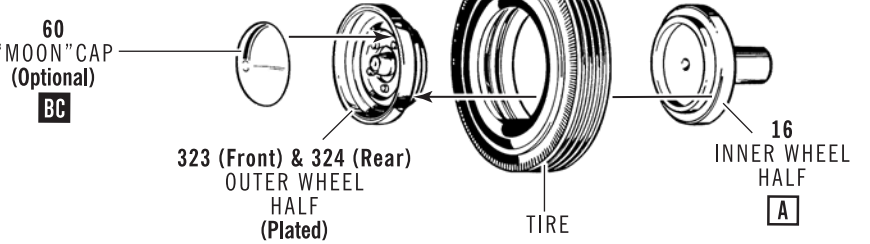

INTERIOR ASSEMBLY

7 STOCK/CUSTOM CONSOLE

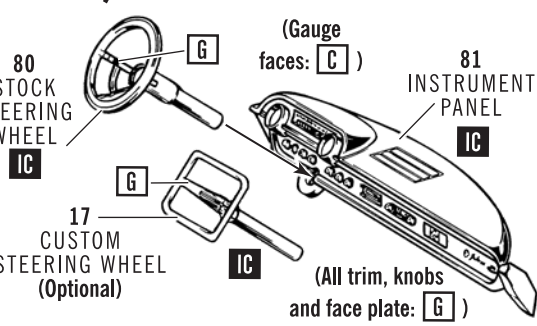

8 CUSTOM CONSOLE

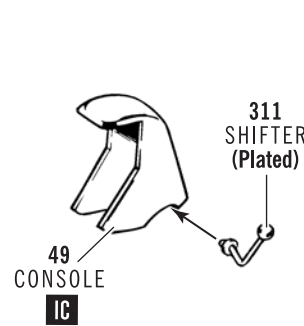

9 STOCK FRONT SEATS (ASSEMBLE 2)

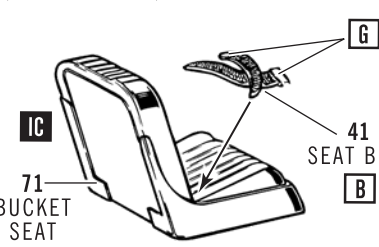

10 CUSTOM FRONT SEATS (ASSEMBLE 2)

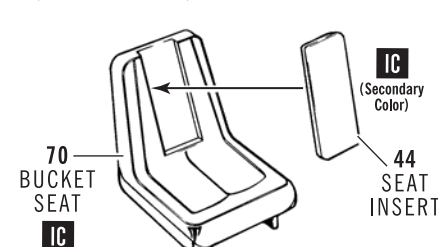

11 STOCK

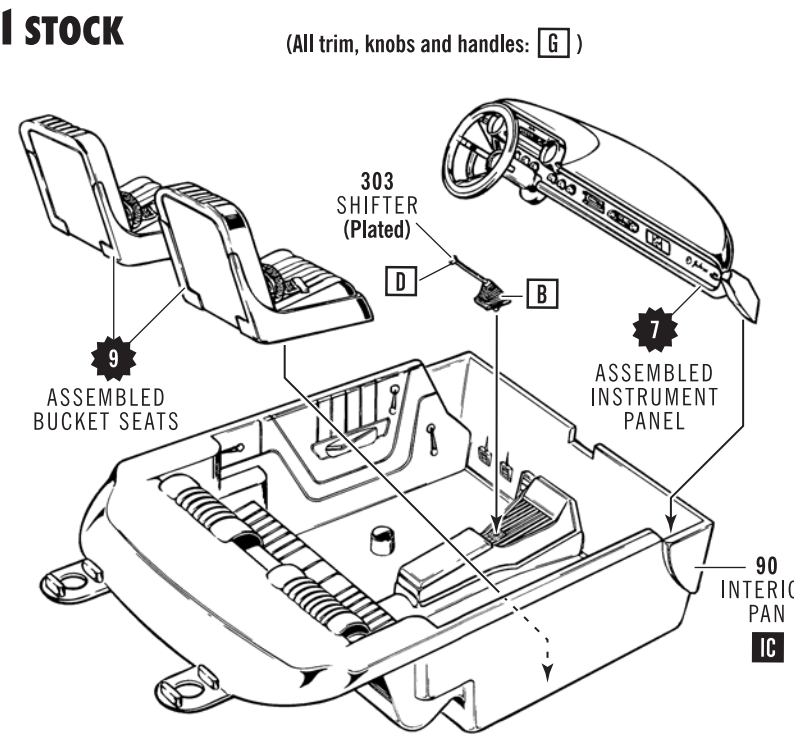

12 CUSTOM

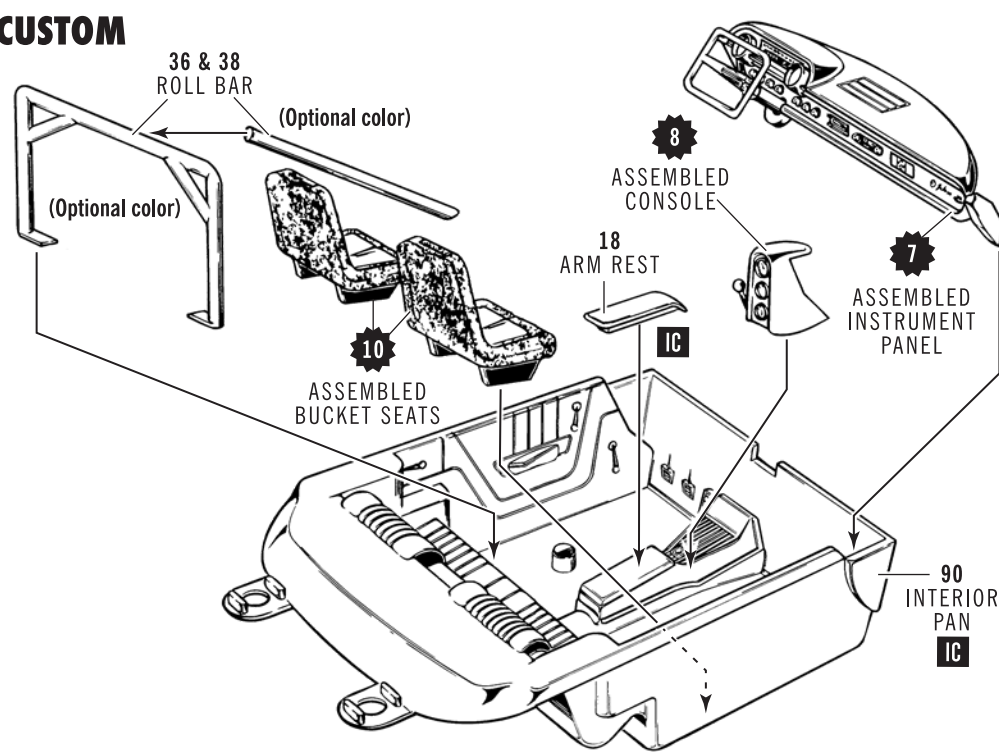

CHASSIS ASSEMBLY

13 STOCK/CUSTOM

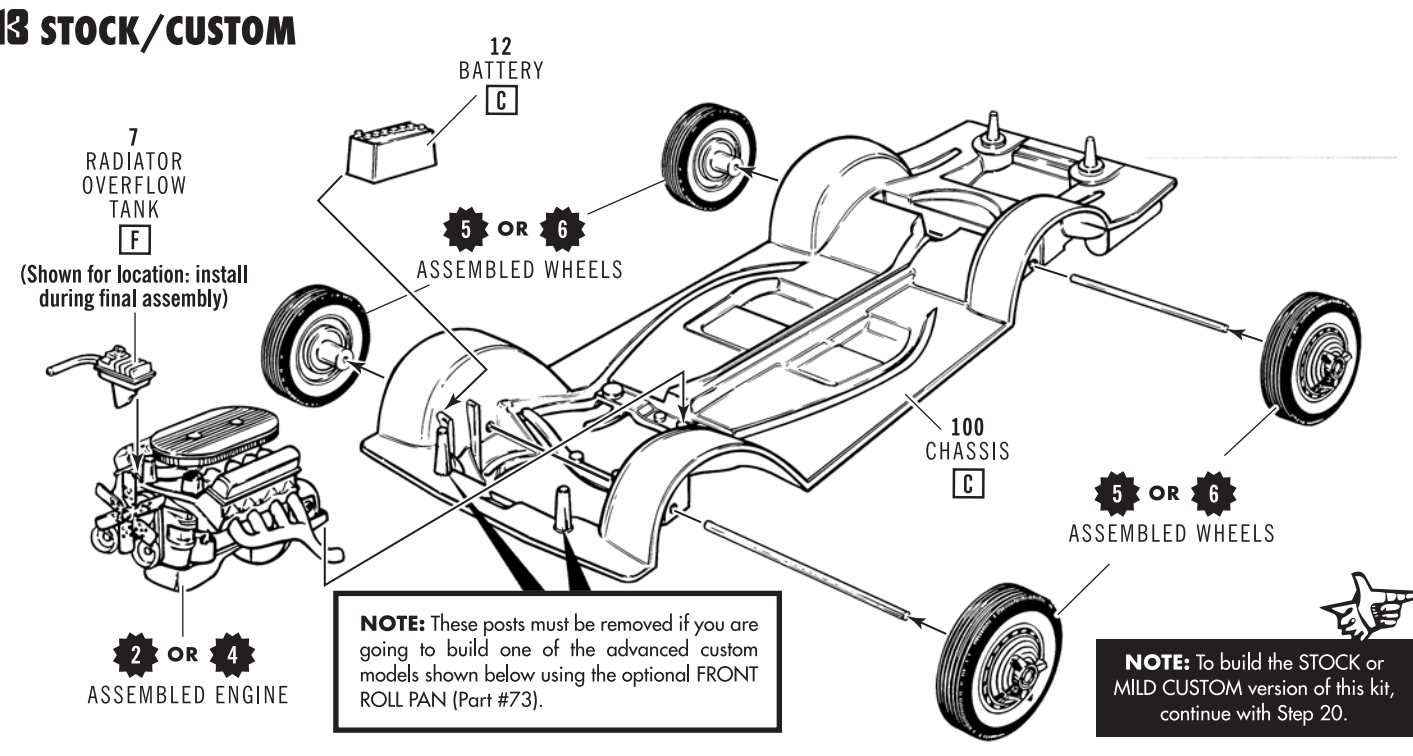

ADVANCED CUSTOM BODY ASSEMBLY (OPTIONAL) NOTE: Plastic modelers putty and sanding sticks are required to build either of the advanced custom options shown here. Neither are included in this kit.

14 FRONT END SUB-ASSEMBLY

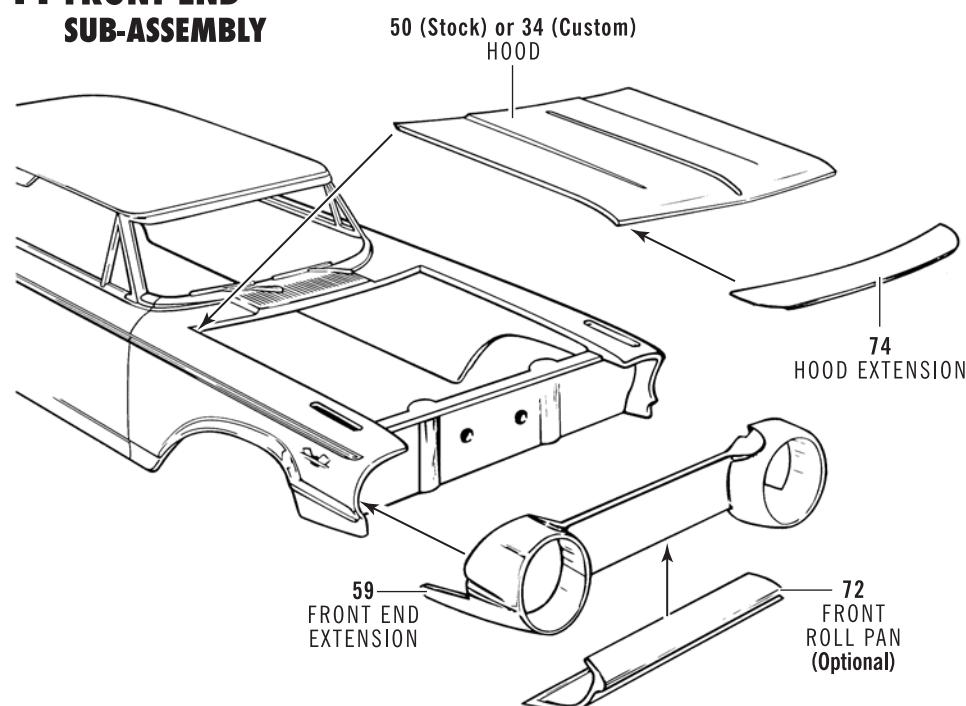

(Complete assembly of steps 14 and 15 then paint BC as a unit)

15 REAR END SUB-ASSEMBLY

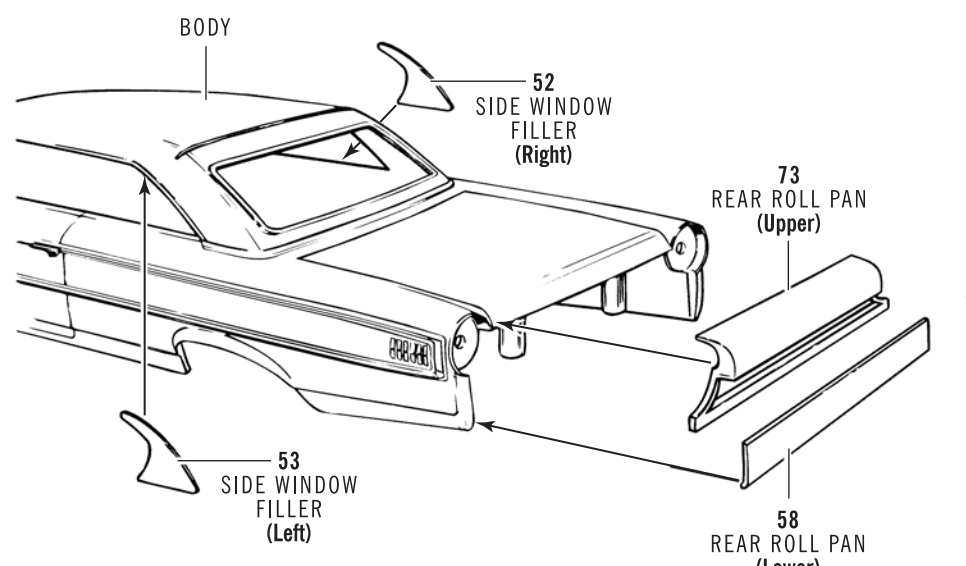

A

NOTE: Bevel the edges of parts to be joined together. This will allow the body to be feathered out onto each part and prevent a sharp line from appearing when finished. Use polystyrene cement for attaching styling sections. Use cement very sparingly and allow to dry thoroughly before applying putty. Apply more than enough body putty to fill the gap between parts and allow enough to feather out onto each part. There will be a certain amount of shrinkage during the drying process and an excessive amount of putty will help eliminate refilling and patching when finishing. Use an applicator to apply and smooth the putty. Don't try to get a perfect job when applying the putty and wait until thoroughly dry before carving, sanding and painting.

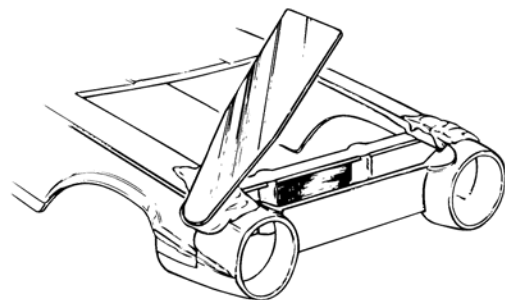

B

For preliminary work, files or coarse sandpaper is helpful. Always use the sanding stick included in the kit to avoid dips and irregularities in the surface. Sand putted areas to a smooth surface, filling air holes and cracks. Let dry and sand again with fine sandpaper. Note: dipping sandpaper in water speeds sanding and adds to the life of the sandpaper. Spray primer on areas that have been sanded and imperfections will become visible. Fill bad spots and re-sand if necessary, checking your work with primer. Repeat until you have achieved a flawless surface.

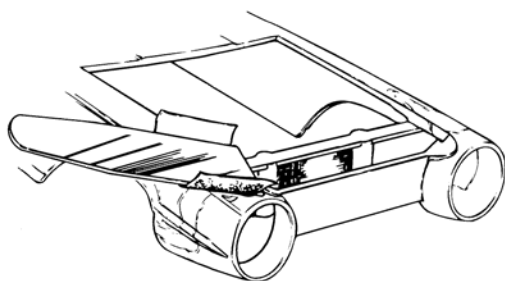

C

Make sure that the car is thoroughly dry and free from dust and lint. You are now ready to apply the finishing touch. Spray paint your body carefully for a professional looking model.

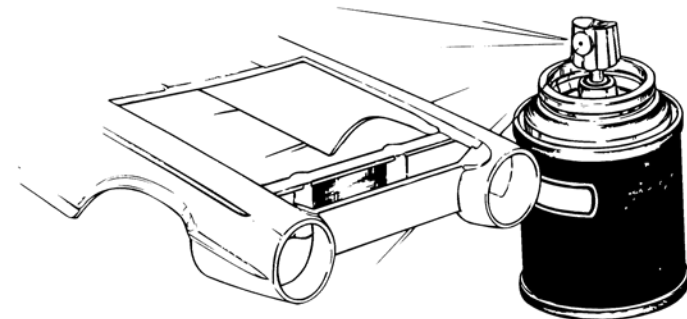

16 FRONT END ASSEMBLY OPTION A

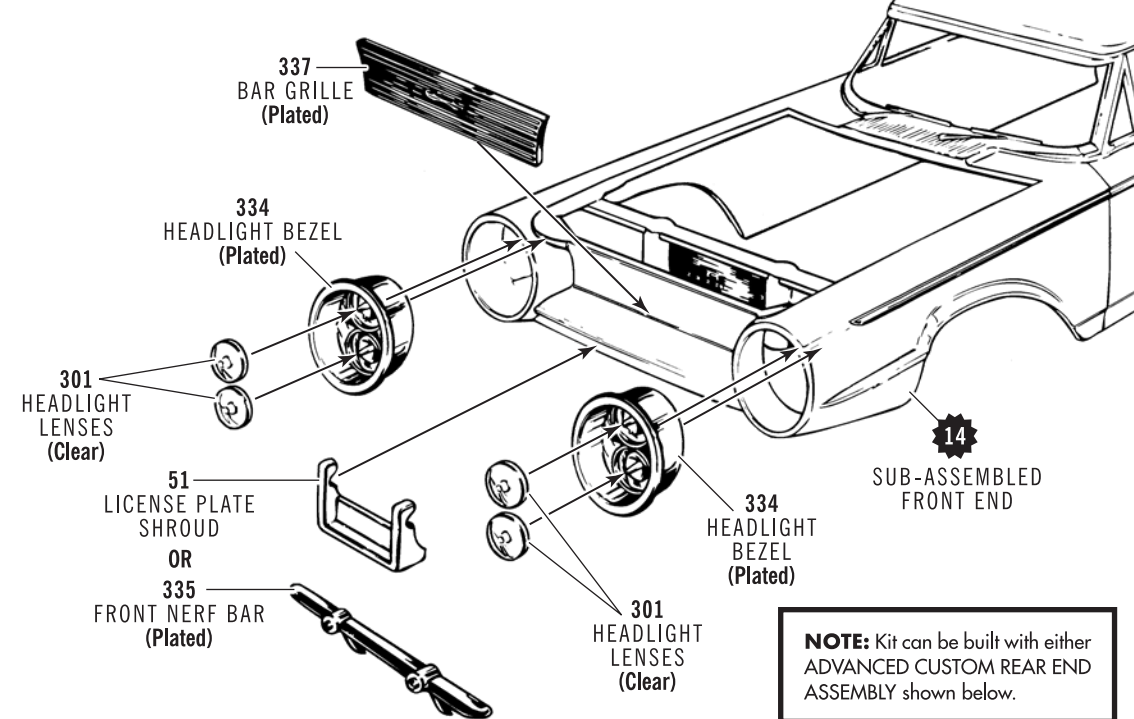

17 FRONT END ASSEMBLY OPTION B

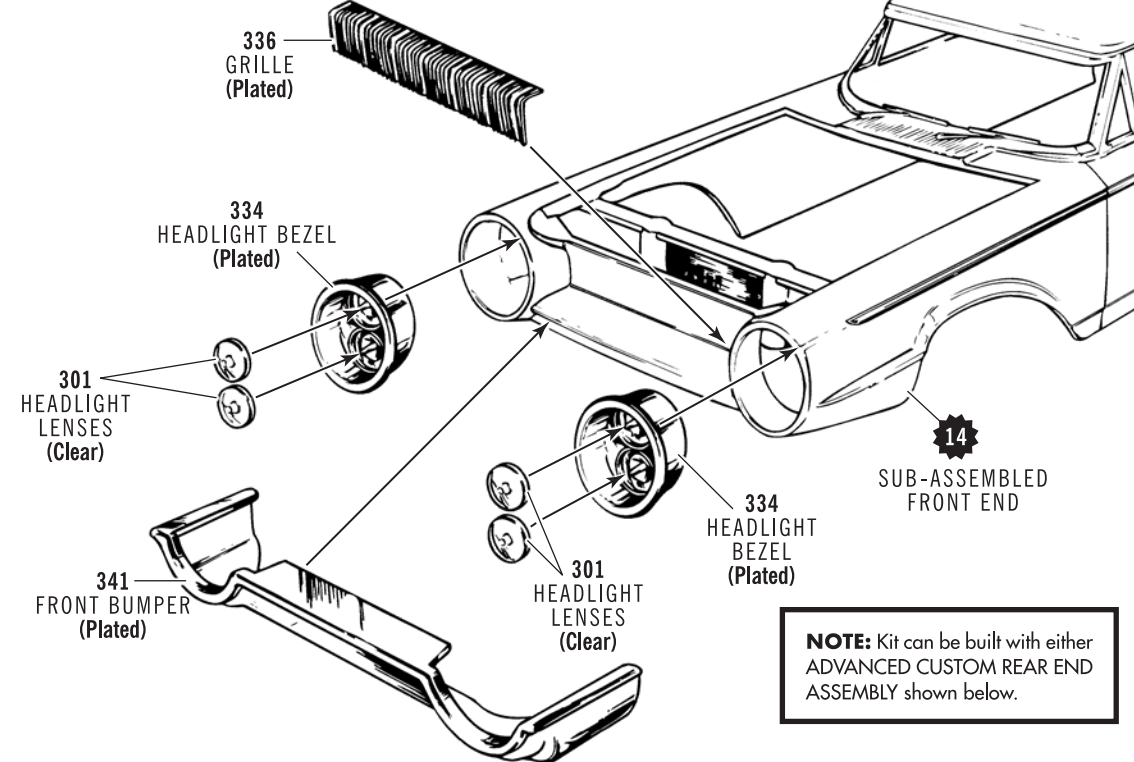

18 REAR END ASSEMBLY OPTION A

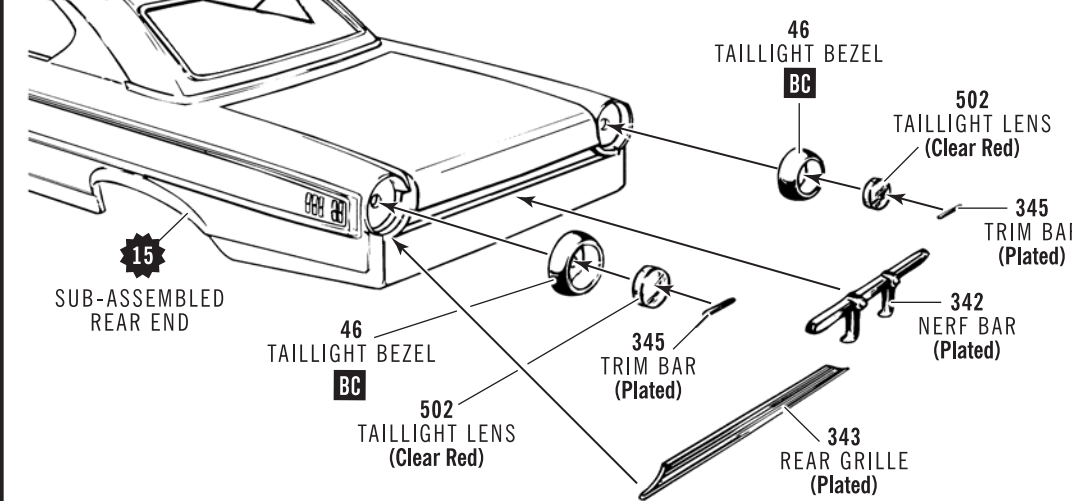

19 REAR END ASSEMBLY OPTION B

